

Barrier-free turnstiles

Optical models

## Fastlane® ClearStyle 200

CS200 | CS 400 | 400 OT | Compact

### Ideal for a museum gallery or lobby

Fastlane ClearStyle™ 200 is the world's most elegant optical turnstile. It combines advanced optical technology with the architect-inspired, minimalist appeal of a transparent pedestal to detect and alarm unauthorized access. With Fastlane, security has never looked so inviting.

<b>COST</b> \$ \$ \$ \$ \$	<b>BARRIER TYPE</b> GLASS   ARM   <b>OPTICAL</b>	<b>FOOTPRINT</b> 
-------------------------------	---	---



#### Advanced intelligence

At the core of every Fastlane, an infrared beam matrix is coupled with a custom-designed microprocessor equipped with neural network programming. Fastlane analyzes pedestrian movement with pinpoint accuracy—it is designed to detect tailgaters following closely behind authorized users. Inherently more secure, this technology also yields the fastest throughput and highest alarm accuracy.

#### Operation

ClearStyle is designed to operate in a normally secure mode, and:

- > Allows access only after system approval
- > Automatically illuminates and sounds a local alarm if someone enters without authorization
- > Has a secondary relay that can trigger CCTV, lock doors, or control elevators

#### User-friendly and safe

The absence of a physical barrier ensures fast throughput and unrestricted movement for all personnel, with safe disabled access and free emergency egress in the event of a fire alarm or power outage.

#### Design

ClearStyle has redefined the optical turnstile category, blurring the line between turnstile and showpiece. Architects played a key role in the patented design of ClearStyle's sleek, acrylic side panels and plated steel ends, which enhance the rich fabric of any well-designed modern lobby.



#### More secure

**Unsurpassed detection and deterrence**

- > Detects tailgaters following behind authorized personnel
- > Patented beam matrix profiles the lane



#### Unsurpassed accuracy

**Intelligence virtually eliminates false alarms**

- > Differentiates body mass from smaller objects
- > Increases acceptance, avoiding guard tune out



#### Fastest throughput

**Greater return on investment**

- > High processing speed reduces traffic build-up
- > Lack of barrier ensures quick user acceptance



#### Elegant aesthetics

**Architect-inspired design**

- > Takes up less space – only 25 inches long
- > Chevron LED illuminates, indicating alarm and direction



#### Outstanding reliability

**Maximum uptime improves bottom line**

- > Fewer failures mean lower repair costs
- > Minimizes need for extra guards

Barrier-free turnstiles

Optical models

## Fastlane® ClearStyle 200

CS200 | CS 400 | 400 OT | Compact

### Materials

- > Tops: Black Perspex®
- > Side panels: glass-like Perspex® Green Silica
- > Ends: 304 stainless steel

A variety of premium and custom options are available to ensure Fastlane complements building aesthetics.

### Visitor management

Fastlane features an optional visitor management input. When activated, unlimited access is allowed for a designated period, after which the system returns to its secure state.

### Disabled access

Fastlane is compliant with ADA as well as most international standards. A wider lane using the same slim pedestals allows for wheelchair or cart access. Audio/Visual feedback is standard.

### Options/Accessories

- > Fastlane Technical Services
- > Fastlane Floor Protector
- > Fastlane Infill System
- > Fastlane Remote Control

Please see Fastlane accessories data sheets for additional details.

### Technical specifications

#### Pedestal dimensions (standard and ADA)

- > Height: 40.5" (1,030 mm)
- > Width: 6.89" (175 mm)
- > Length: 24.69" (627 mm)

#### Lane width

- > Standard lane: 23-28" (600-700 mm)
- > ADA lane: 33-38" (850-960 mm)

#### Speed of throughput

- > 1 person / second (subject to response time of access control system)

#### Display

- > Tri-color graphic display

#### Sounders

- > Single tone sounder: card authorization/alarm condition

#### Optics

- > Pulsed multi-infrared beam array, synchronized for detection
- > Environmentally hardened to avoid sunlight interference

#### Operating modes

- > Bidirectional card in/out on demand
- > Bidirectional card in/free exit
- > Enter only/exit only
- > Lane closed

#### Power requirements

- > Input: 115-230 V AC
- > Output: 24 V DC, 60 W, 2.5 A

#### Inputs

- > Require voltage-free contacts (current sense 1 mA typical)
- > Entry request (normally open)
- > Exit request (normally open)
- > Visitor access (normally open)

#### Outputs

Voltage free relay contacts rated 0.5A, 28 V DC in two groups for the following functions:

#### Output to system

- > Entry (normally closed)
- > Exit (normally closed)
- > Alarm (normally closed)

#### Flow control and alarm outputs

- > Ready for entry (normally closed, normally open, common poles)
- > Ready for exit (normally closed, normally open, common poles)
- > Remote Alarm (normally open)

#### Certifications (power supply only)

- > UL 60950-1, 2nd edition
- > CSA C22.2 No. 60950-1-07, 2nd edition

Due to continuous improvements, specifications are subject to change without prior notice.

### Details

#### ClearStyle 200 dimensions (standard, single lane)

Please see the ClearStyle 200 Drawing Pack for additional details.

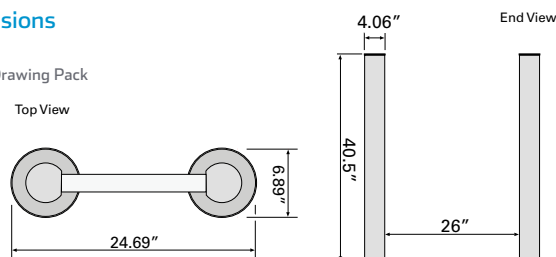

With thousands of systems installed on 6 continents, Fastlane is a world leader in elegant and intelligent optical turnstiles.

Manufactured by Integrated Design Limited. Fastlane is a registered trademark of IDL, 1995.

